

Driving boss is set at driving machine shaft.

And driving boss is fastened by shoe support and bolts.

Rubber bushes are pressed into shoe support and shoes.

Shoes and shoe support are fastened by link plates with bolts.

Non-Asbestos type linings are set at shoes so that they are able to touch drum.

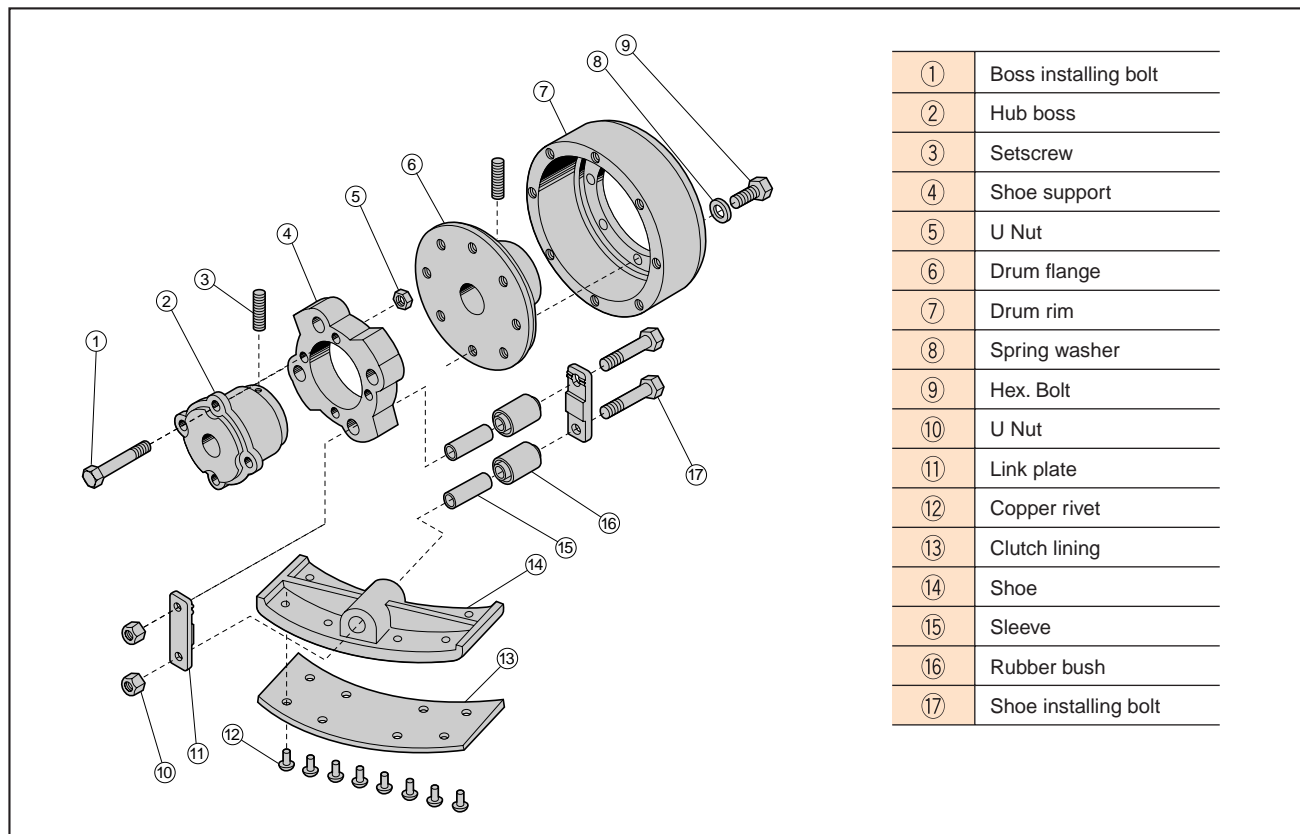

### Operation

Power could not be transmitted at driving machine stopping as drum and driving unit are not touching. When rotation speed of driven machine increases, shoe starts to be compressed to drum by centrifugal force and slips to driven machine transmitting power. And when rotation speed of driven machine becomes rated speed, there is no more slipping and make transmission of 100 % power.



C-136



C-53